

### Legend

- Sign location
- Cone line
- No parking cones
- Pedestrian barrier
- Diversion route
- Closed carriageway
- Marshal
- Traffic signal
- Pedestrian signal

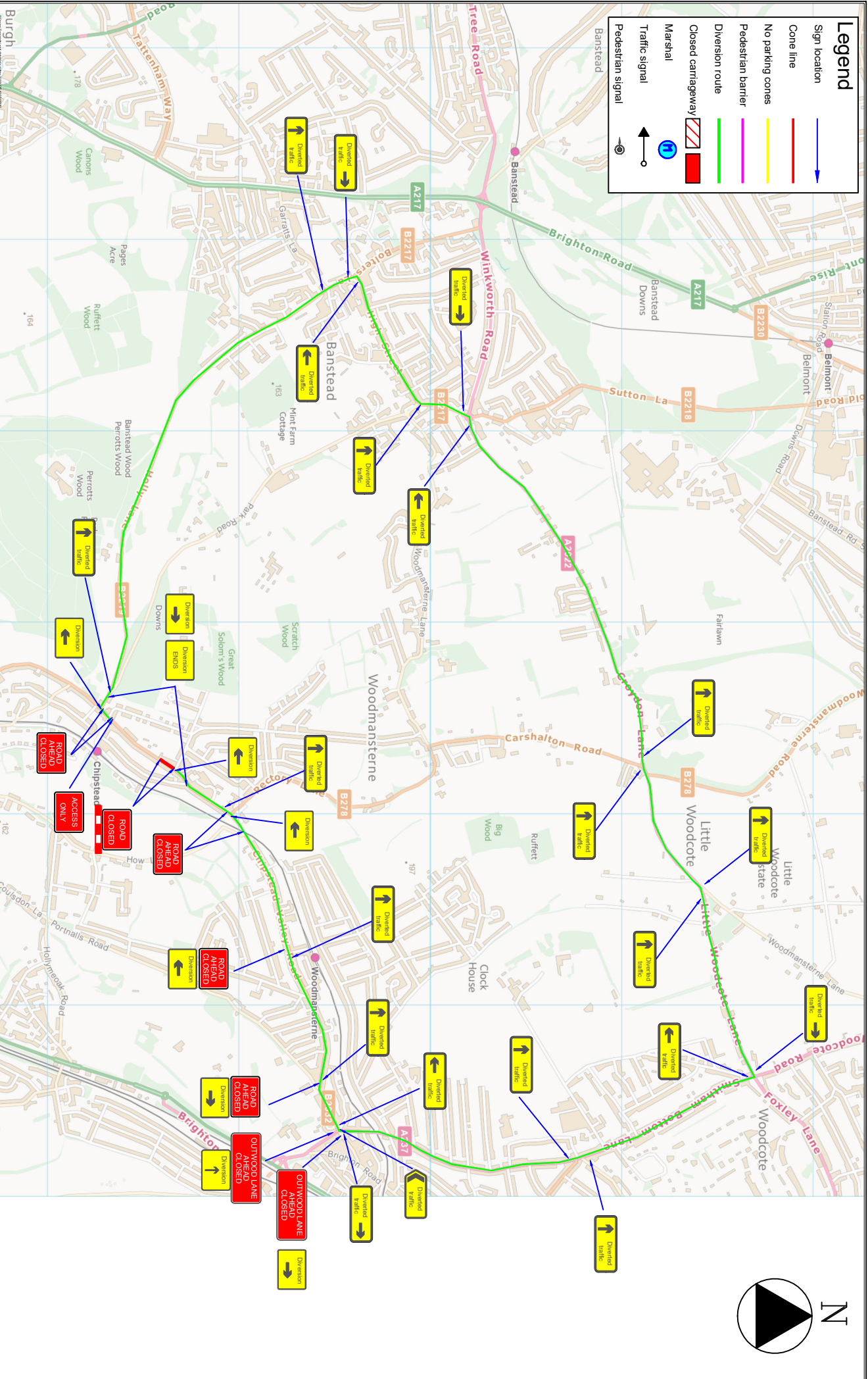

## Traffic Management Layout

### Outwood Lane

**Traffic Management Notes:**

1. This traffic management drawing is a proposal to be verified, accepted and authorised by the relevant highway authority.
2. All temporary traffic management locations are indicative and clearly and are subject to approval from the on-site foreman, supervisor or RL/NO.
3. All carriageway widths for stalling lines through the site to be a minimum of 3.25m. Wide vehicles should be highlighted.
4. For environmental design management to meet the requirements of the named client and may contain design or innovative features due to site constraints which are not standard.
5. This traffic management drawing is a proposal to be verified, accepted and authorised by the relevant highway authority.
6. The client is responsible for ensuring that the traffic management drawing is in accordance with the relevant highway authority's requirements and is safe.
7. The client is responsible for ensuring that the traffic management drawing is in accordance with the relevant highway authority's requirements and is safe.
8. The client is responsible for ensuring that the traffic management drawing is in accordance with the relevant highway authority's requirements and is safe.
9. The client is responsible for ensuring that the traffic management drawing is in accordance with the relevant highway authority's requirements and is safe.
10. The client is responsible for ensuring that the traffic management drawing is in accordance with the relevant highway authority's requirements and is safe.